



6 Gold-plated silver terrine with the coat of arms of Elector Max Emanuel, Paris, 1714/15

7

Commode 'with nymphs', Charles Cressent, Paris, c. 1730/1735



8 Writing utensils of Madame Pompadour, Sèvres porcelain manufactory, 1760/61



9 Nymphenburg Palace, painting by Bernardo Bellotto, also called Canaletto, 1761



10 Crown of the kingdom of Bavaria, Martin Guillaume Biennais, Paris, 1806

UPPER FLOOR

Residence Museum / Upper floor

- 12/13 Staircase to Black Hall/ Black Hall ■
- 14 Yellow Staircase ■
- 14a–c Halls of the Battles ■
- 14d–h 18th- and 19th-century table culture ■
- 15–21 East Asian Collection and St Cecilia's Chapel ■
- 22–31 Electoral Apartments ■
- 32 All Saints' Corridor ■
- 33–41 New Court Garden Halls and Charlotte Rooms ■
- 42–45 Charlotte Corridor and Broad Staircase ■
- 46–53 Trier Rooms ■
- 54 Hall of the Knights of St George/ Conservatory exhibition ■
- 55–62 Ornate Rooms with Green Gallery ■
- 63–66 Rear chambers of the Ornate Rooms ■
- 67–69 Papal Rooms ■
- 71 Golden Hall ■
- 72 Queen Mother's Staircase ■
- 94 Chapel Staircase ■
- 95 Reliquary Chamber ■
- 96/89 Gallery of the Court Chapel ■
- 97–98 Anteroom and Ornate Chapel ■
- 99 Antler Corridor ■
- 100–102 Former Chambers of the Council of State ■
- 103 Guard's Hall ■
- 104–109 Stone Rooms ■
- 110–112 Hall of the Four White Horses, Imperial Hall, Imperial Staircase ■
- 113–114 Theatine Corridor ■
- 115–127 King's Building ■
- 116a–d Silver collection ■
- 128–129 Collection of Miniatures ■

- Accessible museum rooms
- Collection rooms
- Rooms that are not part of the museum
- ▼ Access and Exit King's Building
- WC / Lift

Bayerische Verwaltung der staatlichen Schlösser, Gärten und Seen
info@bsv.bayern.de · www.schloesser.bayern.de
[#schloesserbayern](https://www.instagram.com/schloesserbayern) · [schloesserblog.bayern.de](https://www.instagram.com/schloesserblog.bayern.de)



03/2025

Selected rooms on the upper floor



e King's Building



f Stone Rooms



e Ornate Rooms



h Green Gallery

U Odeonsplatz

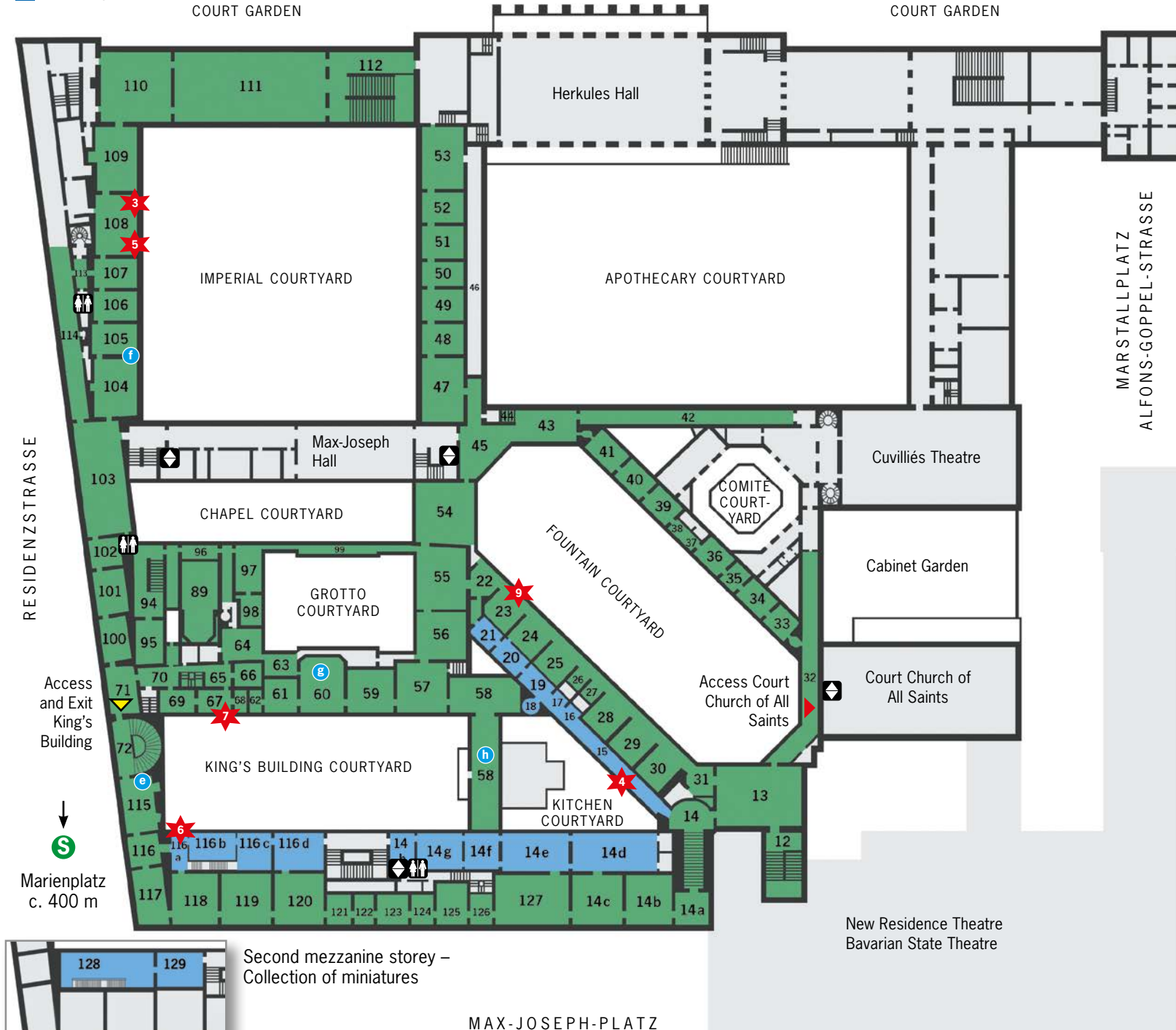

Second mezzanine storey –
Collection of miniatures

Munich Residence

RESIDENCE MUSEUM
TREASURY
CUVILLIÉS THEATRE



Bayerische
Schlösserverwaltung



Albert Füracker, MdL
State Minister

We wish you a fascinating visitin to Munich Residence!



Martin Schöffel, MdL
State Secretary

Munich Residence

Residence Museum/Treasury/Cuvilliés Theatre

For centuries the Munich Residence was the political and cultural centre of first the dukes, then the electors (from 1623) and finally the kings of Bavaria (1806–1918). As the residence and seat of government of the Wittelsbachs, the history of this palace is inseparable from that of Bavaria's ruling dynasty. The various rulers furnished and extended the rooms to suit their own personal tastes, engaging important artists for the purpose. The Residence was also the place where rulers kept their art collections and treasure.

Opening times of the Residence Museum and Treasury

April–18 Oct.: 9am–6pm
19 Oct.-April: 10am–5pm
Last admissions 5pm or 4pm

♿ Museum rooms only accessible via a number of steps or a staircase

A free audio guide (German, English, French, Italian, Spanish, Russian, Arabic, Chinese and Japanese) to the Residence Museum and the Treasury can be obtained at the entrance.

Certain rooms may be inaccessible to the public at short notice when an event is being held in the Residence.

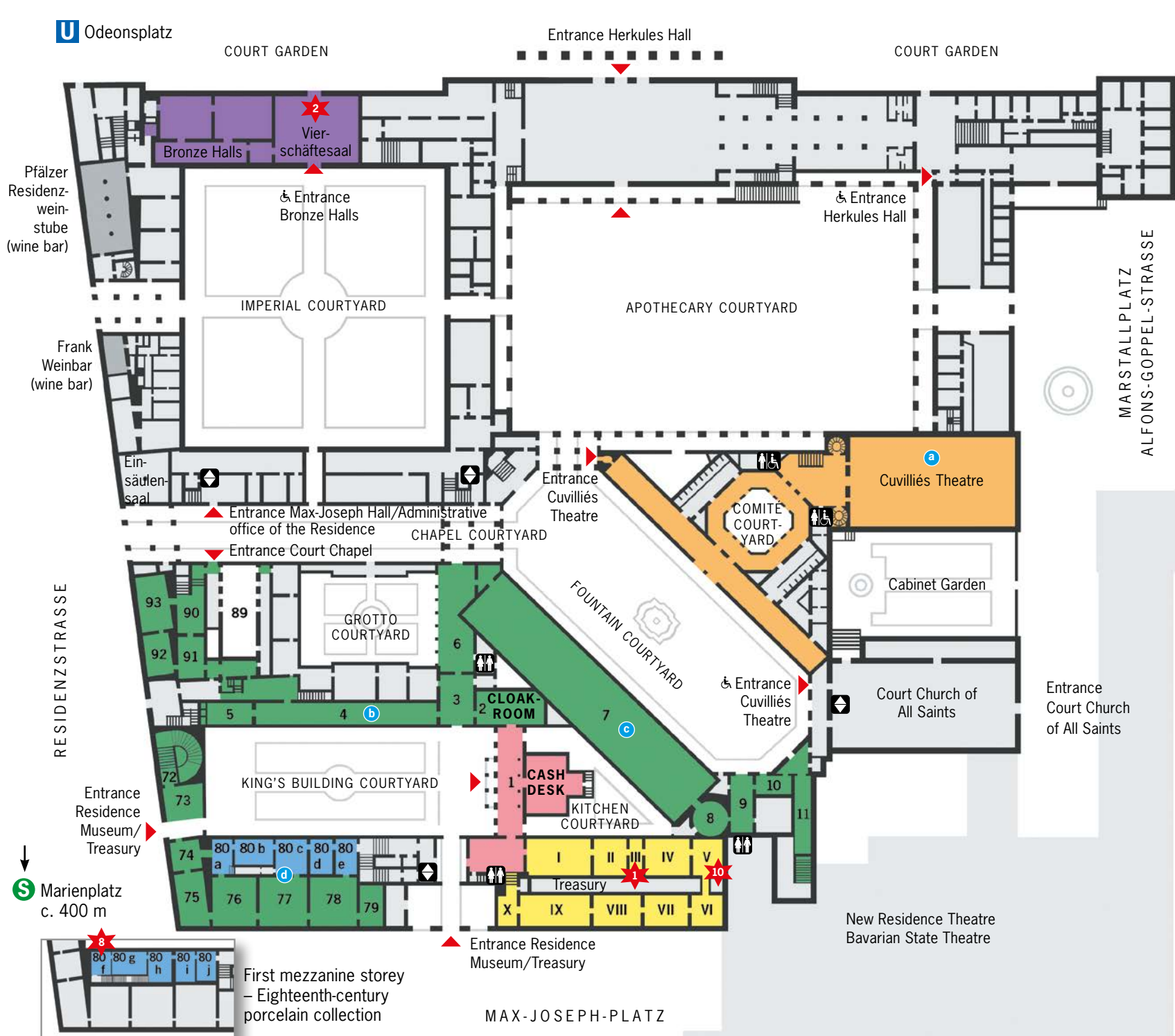

Selected rooms on the ground floor



a Cuvilliés Theatre



b Ancestral Gallery



c Antiquarium



d Nibelungen Halls

Opening times of the Cuvilliés Theatre

April–26 July: Mon.–Sat.: 2pm–6pm
Sun./public holidays: 9am–6pm
27 July–7 Sept.: daily 9am–6pm
8 Sept.–18 Oct.: Mon.–Sat.: 2pm–6pm
Sun./public holidays: 9am–6pm
19 Oct.–March: Mon.–Sat.: 2pm–5pm
Sun./public holidays: 10am–5pm
Last entrance: 5 respectively 4pm
♿ Access via ramp, toilet for the disabled available

Residence Museum/Ground floor

- Vestibule – entrance area
- 3 Garden Halls – cloakroom
- 4–5 Ancestral Gallery and Porcelain Cabinet
- 6 Grotto Courtyard
- 7 Antiquarium
- 8–11 Octagon and staircase to Black Hall
- 73–79 Nibelungen Halls in the King's Building
- 80a–j 18th- and 19th-century porcelain collection
- 89 Court Chapel (accessible from gallery)
- 90 Chapel Staircase
- 91–93 Maximilian I' Summer Apartement (Parament Chambers)

Treasury

- X Goldsmith's work spanning several centuries from the Middle Ages to the neoclassical era

Cuvilliés Theatre

Created by the architect François Cuvilliés the Elder and Munich court artists from 1751 to 1755, this court theatre is a masterpiece of rococo art

- Entrance, cash desk, museum shop
- Bronze halls
- Collection rooms
- Accessible museum rooms
- Rooms that are not part of the museum
- Treasury
- Cuvilliés Theatre
- Entrances
- WC / Lift

Information:
Verwaltung der Residenz München
Residenzstraße 1 · 80333 München
Tel. + 49 89 29067-1 · Fax +49 89 29067-225
www.residenz-muenchen-blog.de · www.residenz-muenchen.de

HIGHLIGHTS

- St George's reliquary**, Munich goldsmith work, between 1586 and 1597



- Bronze sculpture of the Tellus Bavarica**, Hubert Gerhard, Munich, before 1589



- Tapestry** showing the deeds of Otto von Wittelsbach, Hans van der Biest from a design by Peter Candid, 1604/1611



- Candlestick** in the form of a lion made of Japanese porcelain, c. 1670 to 1690

- Augsburg silver clock**, Johann Andreas Thelott et al., c.1690/1698

